



Located at I-94 & Sprinkle Road · Kalamazoo, Michigan

Incomparable Rates Starting at \$2.95 PSF (NNN).

Flexible Terms Available, Including Short-Term Accommodations.

MIDLINK EAST is a world-class, 857,000 square-foot facility with high-capacity infrastructure and dual rail service perfect for high-bay warehousing, distribution and heavy manufacturing. Easily accessible from I-94, the location offers a world-class business park environment with significant Renaissance Zone and Foreign Trade Zone benefits.

Space Available

Inquire for more information

Building

- 38'-42' clear height
- 40' x 80' column spacing
- Dual rail spur
- High-capacity cranes (up to 50 tons)
- Air rotation heating units
- High efficiency T-5 fluorescent light fixtures
- Heavy power
- Fully sprinklered
- Heavy floor-load capacity (1,000 LBS/SF)
- Epoxy and concrete floor
- New interior paint throughout
- Insulated steel stud/drywall demising walls
- Aluminum and glass commercial-style entry
- Truck court with automated gate (240' wide)

Central Location

- 1 hour south of Grand Rapids
- 2 hours west of Detroit
- 2 hours east of Chicago
- 3 ½ hours north of Indianapolis

Utilities

- Fiber optic: dual sonnet ring available
- Electric power: 13,800V @ 60MVA
- Natural gas: 167,515 therms per month @ 20 psi
- Kalamazoo city water: 3 independent feeds looped

Renaissance Zone and Foreign Trade Zone

Tax Savings through 2017 (with extensions possible):

- Abatement –Michigan Corporate Tax
- Abatement –Personal Property Tax
- Abatement –Real Property Tax
- PA 198 Abatements Available
- Foreign Trade Zone Available

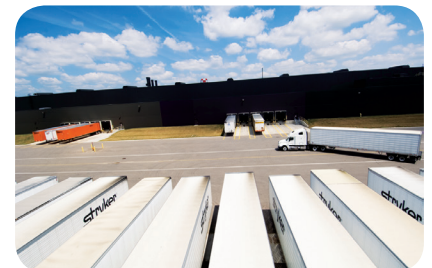

For More Information, Contact:

Matt Callander, CCIM

269-349-1000 (Office)

269-271-5187 (Mobile)

mcallander@ccmichigan.com

David Keyte

269-373-8104 (Office)

269-806-0554 (Mobile)

dkeyte@ccmichigan.com

Floor Plan

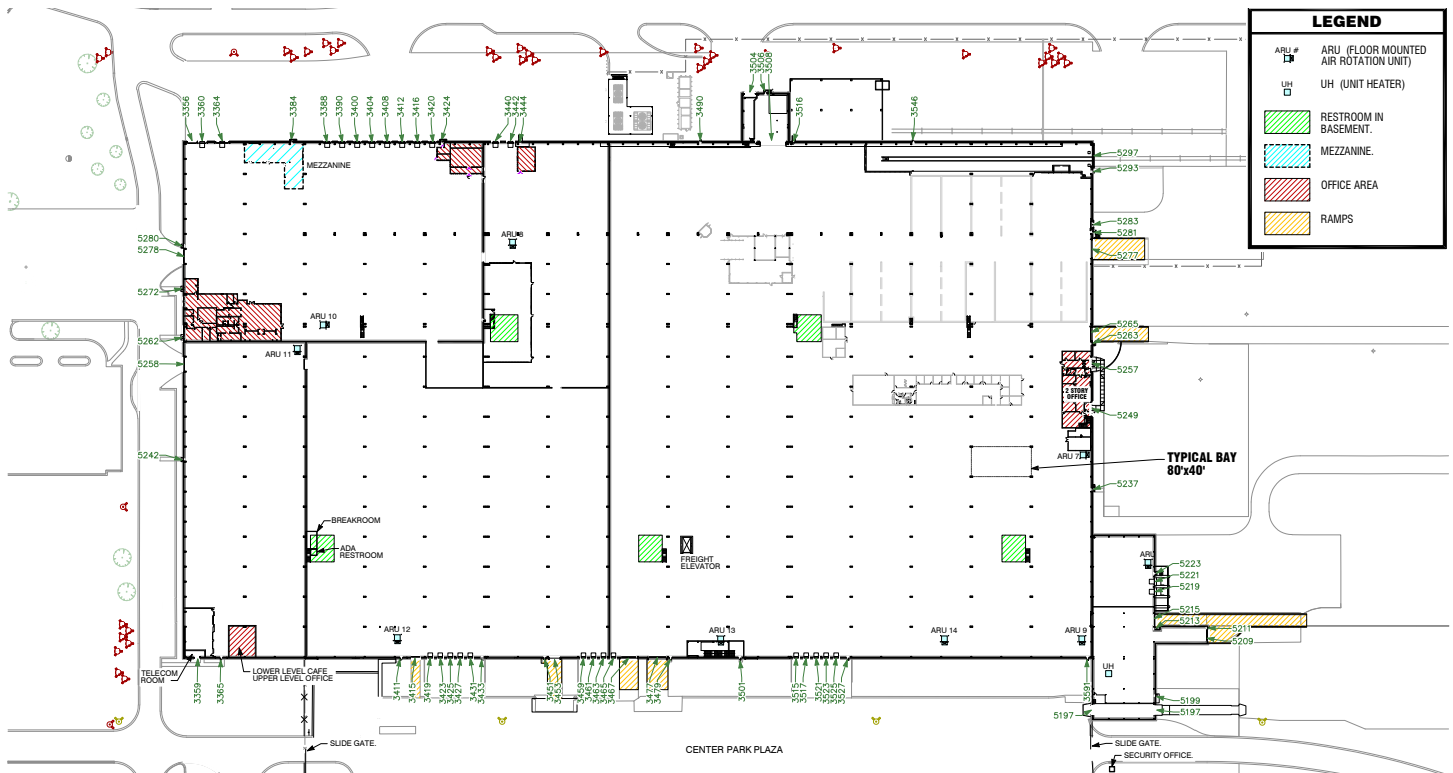

Overall Park Site Plan

